

RIVERHOMES

Hartington Court
Chiswick W4

£425,000
Share of Freehold



Perched on the top floor of the iconic Art Deco landmark, Hartington Court, this beautifully appointed two-bedroom apartment enjoys an exceptional riverside setting. With sweeping views across the Thames towards Kew and Chiswick Bridge, the bright reception room is perfectly positioned to capture the ever-changing light over the water. The interiors are thoughtfully arranged, featuring a sleek fitted kitchen, two generous double bedrooms—one with bespoke fitted wardrobes—and a well-appointed family bathroom. A lift serves the building, while residents have access to communal gardens that unfold towards the river’s edge. Unallocated parking is available within this sought-after gated development. Council tax band E.

ENERGY PERFORMANCE CERTIFICATE

Score	Energy rating	Current	Potential
92+	A		
81-91	B		
69-80	C		80 C
55-68	D	66 D	
39-54	E		
21-38	F		
1-20	G		

KEY INFORMATION

Local authority:	London Borough of Hounslow
Internal area:	575 sq. ft. / 53.42 sq. m.
Lease length:	Approx. 921 years
Ground rent:	Approx. £200 per annum
Service charge:	Approx. 3,568 per annum
Reserve fund:	Approx. £1,964 per annum

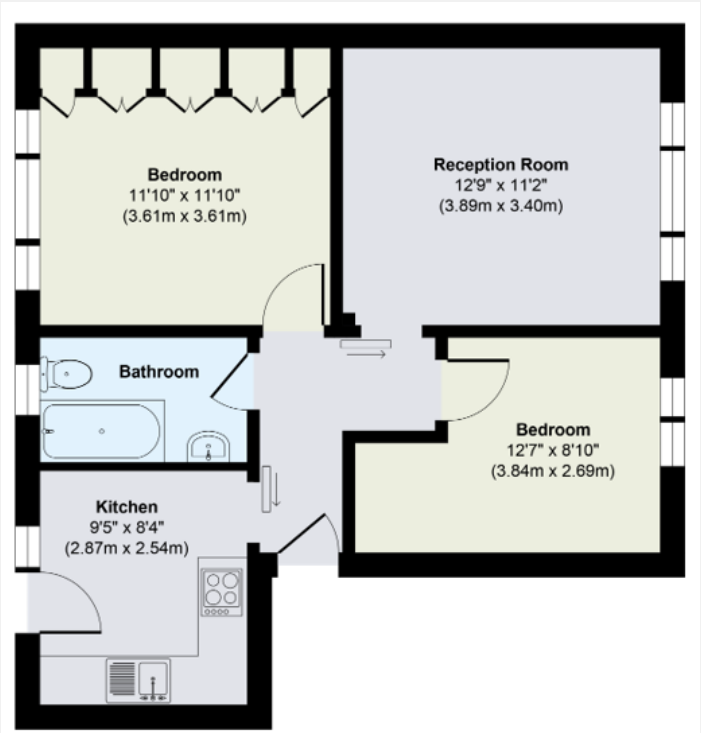

World Waterside Ltd trading as riverhomes for themselves and its clients give notice that 1: They are not authorised to make or give any representations or warranties in relation to the property either here or elsewhere, either on their own behalf or on behalf of their client or otherwise. 2: These particulars do not form part of any offer or contract and must not be relied upon as statements or representations of fact. Any areas, measurements or distances are approximate. The text, photographs and plans are for guidance only and are not necessarily comprehensive. 3: It should not be assumed that the property has all necessary planning, building regulation or other consents and any services, equipment or facilities have not been tested. 4: Lease details, service charges, ground rent (where applicable) and council tax are given as a guide only and should be checked and confirmed by your Solicitor prior to exchange of contracts. 5: They assume no responsibility and any intending purchasers or tenants must satisfy themselves by inspection or otherwise as to the correctness of each of the statements contained within these particulars. If you require clarification of any points please contact us.